

Certified according to DIN EN ISO 9001

Technical Datasheet & Manual



VTE-C* und VTE-C* (Ex) Carrier-Frequency Pulse Amplifiers



VTE-C*(Ex) Carrier-Frequency Pulse Amplifiers

Description

An integral carrier-frequency pickup detects the r.p.m. of the KEM flow meter through the body of the meter without coming into contact with the measuring medium. The output signal of the pickup is amplified and converted to current or voltage square wave pulses.

Versions VTE-C* (Ex) have Ex-protection EX II 2 G EEx ia IIC T4/T5/T6. Our type EWS separation amplifier is recommended for an intrinsically safe supply of the Ex-versions.

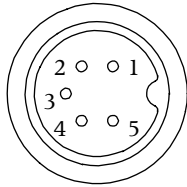
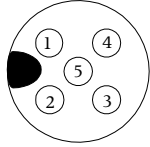
Technical Data

Supply voltage U_B :	UB: +9 bis 29 V DC	
Quiescent current:	IR < 4 mA	
Frequency range:	1.5 up to 3,000 Hz according to flow meter	
Ambient temperature:	-20 up to +50 °C	
Medium temperature:	VTE-CT (Ex) and VTE-CM (Ex): T6: +50 °C, T5: +60 °C, T4: +70 °C VTE-CS (Ex) and VTE-CR (Ex): T6: +80 °C, T5: +120 °C, T4: +120 °C VTE-CT and VTE-CM: +70 °C VTE-CS and VTE-CR: max. +120 °C with a distance > 23 mm between amplifier and flow meter max. +180 °C with a distance > 62 mm between amplifier and flow meter	
Electrical connection:	5-pin amphenol plug type T3362500 or 5-pin binder plug 713 type 09-0433-81-05 pin connection type S 1 =+UB 2= 0 V 3= n.c. 4= open collector signal (collector) 5= open collector signal (emitter)	Amphenol type S 
	pin connection type H 1 =+UB 2= n.c. 3= 0 V, open collector signal (emitter) 4= open collector signal (collector) 5= PE	Binder (M 12) type H 
Housing:	Aluminium, anodised	
Ingress protection:	IP 65 (DIN 40050)	
Weight:	approx. 250 up to 270 g	
IS approval ATEX 100:	 II 2 G EEx ia IIC T4/T5/T6	
Output:	frequency output passive NPN/OC	

Electrical connection

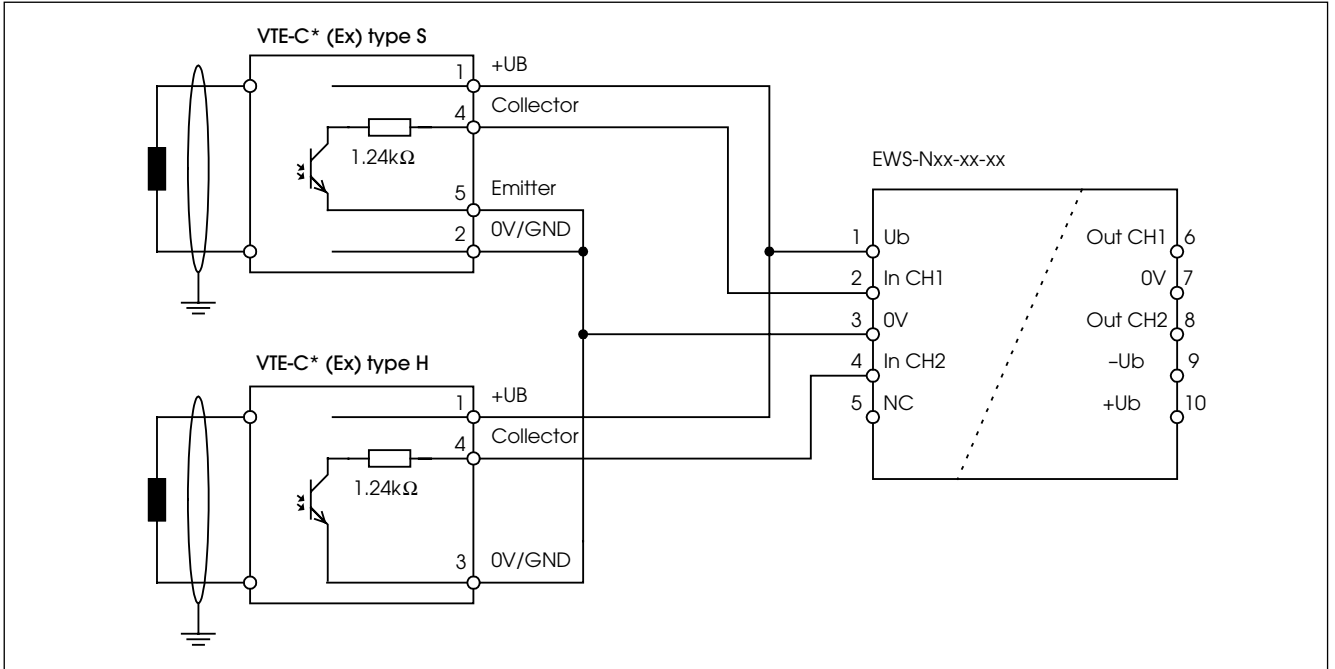

Dimensional Drawing (mm)

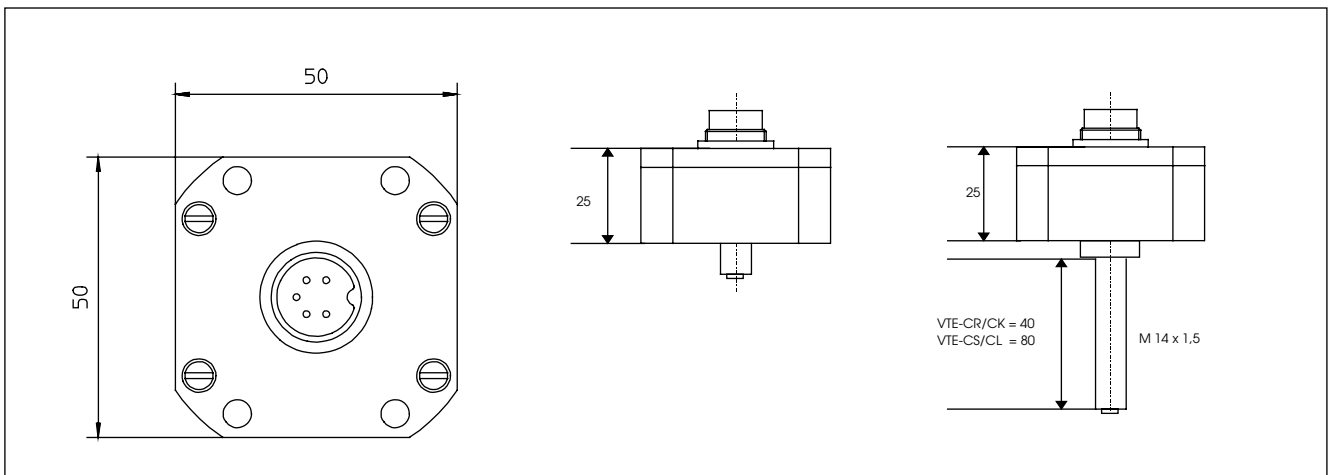

Safety-relevant parameters (only for Ex versions)

Supply circuit (type S connector-pins 1 and 2 / type H connector-pins 1 and 3)

voltage: $U_i = DC\ 30\ V$
current power: $I_i = 100\ mA$
power: $P_i = 750\ mW$
effective internal capacity: $C_i = \text{negligible}$
effective internal inductivity: $L_i = \text{negligible}$

Signal circuit (type S connector-pins 4 and 5 / type H connector pins 3 and 4)

voltage: $U_i = DC\ 30\ V$
current power: $I_i = 100\ mA$
power: $P_i = 750\ mW$
internal resistance: $R_i \geq 1.24\ k\Omega, \pm 5\%$
effective internal capacity: $C_i = \text{negligible}$
effective internal inductivity: $L_i = \text{negligible}$

Ordering Information

VTE - **. *- Ex

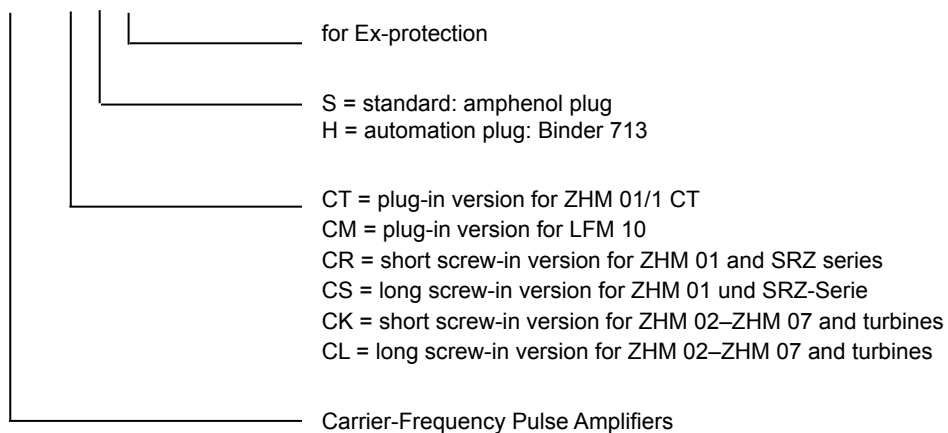

Notes on Installation

The following has to be adhered to:

- a. Installation instructions for electrical devices
Installation instructions for associated intrinsically-safe devices
The »Special conditions for safe use« as per EC-Type Examination Certificate.
- b. The amplifier has to be installed in a way that the max. ambient temperature does under no circumstances exceed +50C (consider self heating).
- c. With cables care should be taken, that the max inductivity and capacity of the respective voltage or gas group are not exceeded.
- d. Exceeding or falling below the regular measuring range will cause invalid frequency output signals.
- e. Shielded cables are to be used as connecting lines.
- f. Generally, supplied units have to be connected by an expert according to EMC stipulations.

Marking of the Pulse Amplifier

KEM Küppers Elektromechanik GmbH

CE 0123 Ex II 2G EEx ia II C T4/T5/T6

DMT 02 ATEX E 218

VTE**-*Ex Ser.Nr. 123456789

-40°C ≤ Ta ≤ 50 °C T6

≤ 60 °C T5

≤ 70 °C T4

Ui = 30 V/DC, Ii = 100 mA, Pi = 750 mW

The test sticker marks the year of building and the person in charge of test.

Contact

NATIONAL

KEM Head Office

Liebigstraße 5
D-85757 Karlsfeld
T. +49/8131/ 59 39 10
F. +49/8131/ 92 60 4
info@kem-kueppers.com

KEM Nord-West & Benelux

Mr. Braun
Im Langen Hahn 44
D-58515 Lüdenscheid
T. +49/2351/97 88 0
F. +49/2351/97 88 31
braun@kem-kueppers.com

KEM South-West & Switzerland

Mr. Cissé
Dahlienweg 35
D-73765 Neuhausen
T. +49/7158/ 98 56 82
F. +49/7158/ 98 56 83
cisse@kem-kueppers.com

KEM South-East & Austria

Mr. Baumüller
Liebigstraße 5
D-85757 Karlsfeld
T. +49/8131/ 59 39 124
F. +49/8131/ 92 60 4
baumueller@kem-kueppers.com

INTERNATIONAL

KEM Head Office

Mr. Kühne
Liebigstraße 5
D-85757 Karlsfeld
T. +49/8131/ 59 39 25
F. +49/8131/ 92 60 4
international@kem-kueppers.com

KEM China

Mr. Shaw
Rm.2429, JinYuan Office
Building, No. 36,
CN- BeiYuan Road, Beijing 100012
T. +86/10/52 00 37 38
shaw@kem-kueppers.com

SERVICE

Service & Repairs

Wetzeller Straße 22
D-93444 Bad Kötzing
T. +49/9941/ 94 23 0
F. +49/9941/ 94 23 23
info@kem-kueppers.com

More distributors and partners can be found at:
www.kem-kueppers.com



www.kem-kueppers.com

info@kem-kueppers.com